

Set-up Instructions for FREEDOM Wireless™ Headset Fire/Safety & Industrial

1. Charge the headset with the supplied car or wall mount charger (headset is not fully charged from the factory)
2. Connect the WS-I0710 module to the intercom/radio via an appropriate interface cord (make sure it is active).
 - Please power the transceiver using our supplied power cable (must be hardwired), and connect to a 12-24 volt power source (see caution notes below). **DO NOT USE WALL MOUNT CHARGER!** Once power is supplied, the LED will then go steady YEL, then blinking GRN followed by a steady GRN.
3. To turn on your Freedom Wireless™ Headset, press power or pairing black button until LED turns green. Wait 10 to 15 seconds for Headset and Transceiver to pair-up. If after 15 seconds LED light on Headset and Transceiver stay green, proceed to pairing procedure on page 2.

FREEDOM Wireless™ Headset

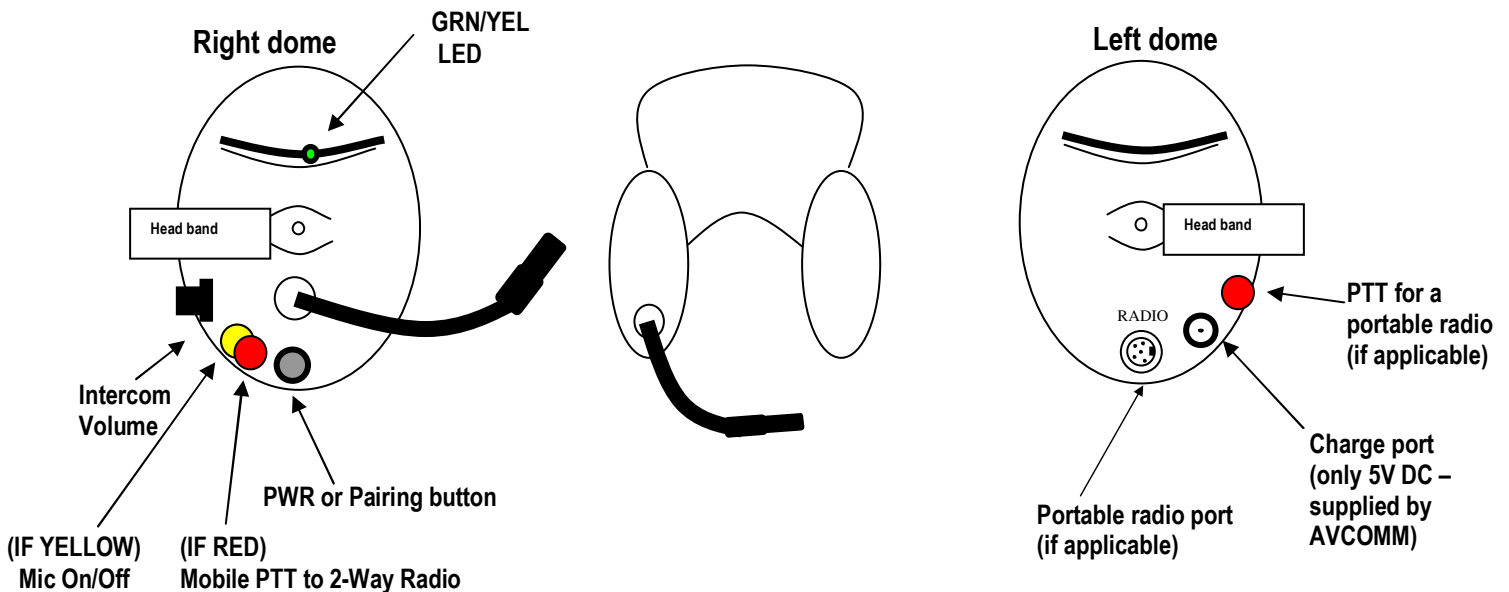

LED Status (at Headset)

- No Light : Power off
- Steady GRN : Power on and ready for connection.
- Blinking GRN in every 2 seconds : Connection Established.
- Steady yellow and GRN/YEL blinking alternatively: in pairing mode
- Number of YEL blinking at the powering up shows the battery level.
 - 3 blink – over 80 %
 - 2 blink – over 50 %
 - 1 blink – over 20 % (*needs recharging*)

WS-I0710 (Portable Transceiver Unit)

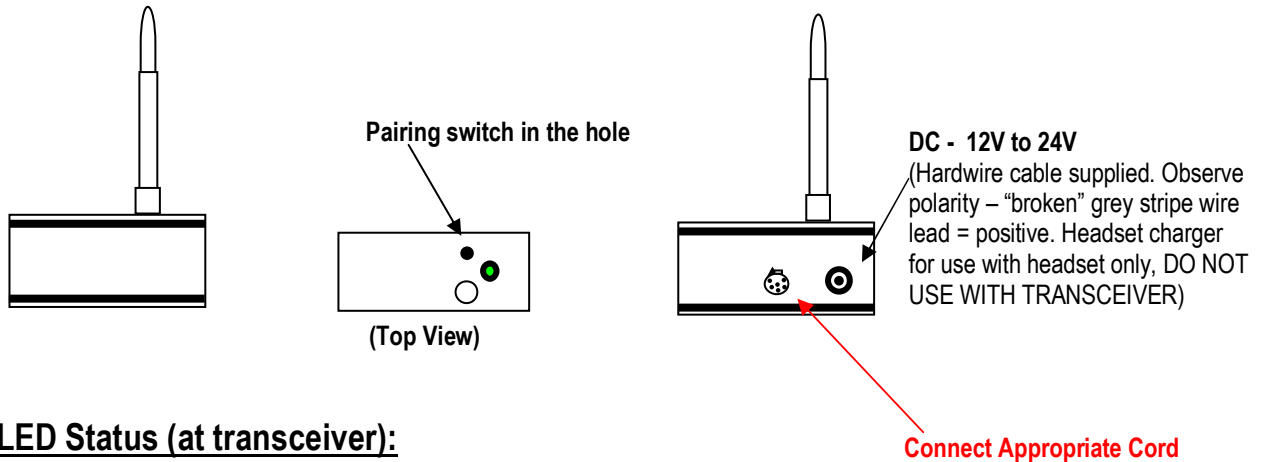

LED Status (at transceiver):

- No Light : Power is off.
- Steady GRN : Power on and ready for connection.
- Blinking GRN in every 2 seconds : Connection Established.
- Blinking YEL in every 2 seconds : Connection Established and battery is low.
- Steady yellow and GRN/YEL blinking alternatively: in pairing mode
- Number of YEL blinking at the powering up shows the battery level.
 - 3 blink – over 80 %
 - 2 blink – over 50 %
 - 1 blink – over 20 % (*needs recharging*)

Pairing Procedure:

Your Headset comes “paired” when shipped from the factory. However, should your Headset require pairing, please follow these instructions below:

1. Connect the transceiver to an active intercom system and make sure LED is Green.
2. Turn the headset off.
3. Use the small Allen wrench supplied and push pairing switch for 3 seconds. YEL and GRN LED will blink alternately.
4. Press PWR button at headset for 8 seconds until the LED changes to Yellow.
5. The headset and transceiver will auto-connect after the pairing is initiated.

Caution:

- When you are not required to connect, please turn headset power off to conserve the battery.
- The WS-I0710 and WSH Headsets have auto power on/off circuitry; the batteries will be consumed only when the module is connected to an active intercom or headset is in active use
- Supplied 5 volt car or wall charger is for headset only (**do not use to power or charge transceiver**).
- Transceiver Installation: Observe Polarity (Cable hardwire – “broken” grey stripe wire lead = positive).